

Fig.A1

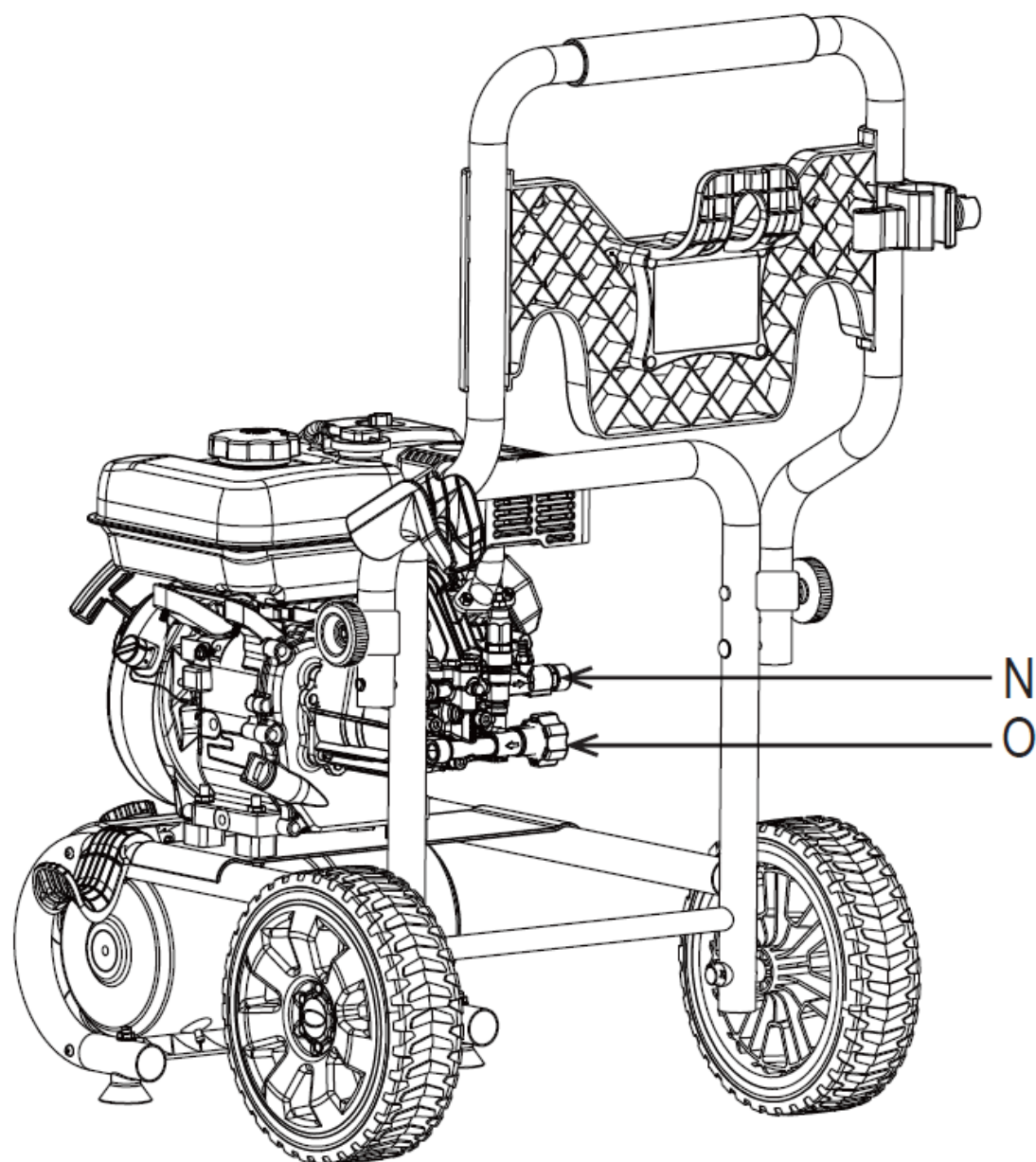

Fig. A2



1	APPLICATION	5
2	DESCRIPTION (FIG. A1 & A2)	5
3	PACKAGE CONTENT LIST	6
3.1	<i>Unpacking</i>	6
4	SAFETY SYMBOLS	7
5	SAFETY INSTRUCTIONS	7
6	ATTACHING WHEEL ASSEMBLY (SEE FIG. 1)	10
7	ATTACHING FOOT ASSEMBLY (SEE FIG. 1)	10
8	RAISING HANDLE (SEE FIG. 2)	10
9	ATTACHING UPPER AND LOWER GUN HOOKS (SEE FIG. 3)	10
10	ATTACHING HIGH PRESSURE HOSE HOOK (SEE FIG. 4)	11
11	ATTACHING ACCESSORY HOOK (SEE FIG. 4)	11
12	ATTACHING THE SPRAY GUN (SEE FIG. 5 & 6)	11
13	ADDING / CHECKING ENGINE OIL (SEE FIG. 7)	12
14	ADDING FUEL (SEE FIG. 8)	12
15	CONNECTING GARDEN HOSE TO PRESSURE WASHER (SEE FIG 9)	13
16	CONNECT HIGH PRESSURE HOSE TO PUMP (SEE FIG. 10).	13
17	PRE-OPERATION CHECK LIST	14
18	STARTING PRESSURE WASHER (SEE FIG. 11-12)	14
19	STOPPING PRESSURE WASHER (SEE FIG. 13)	15
20	USING THE SPRAY GUN (SEE FIG. 14 - 15)	15
21	USING SPRAY NOZZLE (SEE FIG. 16)	16
22	APPLYING DETERGENT	16
23	RINSING WITH THE PRESSURE WASHER	16



24	MOVING THE PRESSURE WASHER.....	16
25	MAINTENANCE.....	17
26	PRE-OPERATION STEPS	17
27	REMOVE DEBRIS	17
28	AFTER EACH USE.....	17
29	MAINTENANCE SCHEDULE	17
30	CHANGING ENGINE OIL.....	18
31	CHECKING DETERGENT SIPHONING TUBE	18
32	HIGH PRESSURE HOSE.....	18
33	SPRAY GUN.....	18
34	SPRAY NOZZLE	19
35	CHECKING SPARK PLUG.....	19
36	REPAIRING LEAKING CONNECTIONS.....	19
37	AIR FILTER	19
38	STORING PRESSURE WASHER	20
39	TROUBLESHOOTING	20
40	TECHNICAL DATA.....	21
41	NOISE.....	21
42	VIBRATION.....	21
43	SERVICE	22



GASOLINE PRESSURE WASHER FPWG2700H-J-EU / FPGWG3100H-J-EU

Thank you for purchasing this superior quality pressure washer from Ford Power Equipment. When operating and maintaining this product as instructed in this manual, your pressure washer will give you many years of reliable service.

Product specifications

This pressure washer operates at 186 bar (FPWG2700H-J-EU) / 213 bar (FPGWG3100H-J-EU) with a flow rate of 8.7 l/min. (FPWG2700H-J-EU) / 9.5 l/min. (FPGWG3100H-J-EU).

This high end residential use system features a 180 CC (FPWG2700H-J-EU) / 208 CC (FPGWG3100H-J-EU) engine, no-flat, foam filled tires, 7.5 m high pressure hose and 4 (FPWG2700H-J-EU) / 6 (FPGWG3100H-J-EU) quick-connect nozzles.

1 APPLICATION

This pressure washer is designed to remove dirt and mould from house siding, decks, garage floors, brick patios, and cement walkways. This unit can be used to clean cars, motorcycles, boats, RV's outdoor furniture, lawn equipment, grills, etc.

It is not designed for professional use.



WARNING! Please read and understand this operating manual before use and keep it for your future reference. Your power tool should only be passed on together with these instructions.

SAVE THIS MANUAL FOR FUTURE REFERENCE

This manual contains important information regarding safety, operation, and maintenance

2 DESCRIPTION (FIG. A1 & A2)

A - Five quick-connect spray tips
B - Fuel tank and cap
C - Choke
D - Fuel valve lever
E - Soap tank
F - Handle
G - 25' high pressure hose
H - Spray gun

I - Locking trigger
J - Pull cord
K - Engine On/Off switch
L - Oil fill and dipstick
M - No flat foam filled tires
N - High pressure hose outlet
O - Water inlet - Grounding stud



3 PACKAGE CONTENT LIST

3.1 Unpacking

- Place box on a level surface
- Remove all items from box except the pressure washer. Make sure all items listed on the packing list are included and not damaged.
- Cut down the sides of the box being careful to avoid hitting the pressure washer.
- Check all loose parts to the following list. Contact your dealer if any loose parts are not included.



WARNING Packing materials are no toys! Children must not play with plastic bags! Danger of suffocation!

Packing List

- Pressure washer
- Quick start guide
- Operator's manual and product registration card
- Spray gun
- Extension wand with quick-connect fitting
- High pressure hose
- FPGW2700H-J-EU : 4pcs Spray nozzles : 0°, 25°, 40° and soap nozzle.
- FPGW3100H-J-EU : 6pcs Spray nozzles : 0°, 15°, 25°, 40° ,soap nozzle, rotating (turbo) nozzle
- Wheels (2pcs)
- Hair pins (2pcs),
- Axles (2pcs),
- Hub caps (2pcs)
- Spray gun hook (upper)
- Spray gun hook (lower)
- High pressure hose hook
- Accessory hook
- Foot (2pcs)
- 4-Cycle engine oil (SAE10W30)





WARNING! Do not attempt to assemble or operate this pressure washer until you have read and understood this entire manual. If you have any problems assembling or operating this unit, contact your dealer or a qualified service centre.













WARNING! Do not operate this pressure washer if any of the parts are damaged or missing until the part is replaced. Using this product with damaged or missing parts can cause damage to the machine or result in serious injury or death.

4 SAFETY SYMBOLS

The following symbols are used in this manual and/or on the machine:

 WARNING !	Indicates a potentially hazardous situation which could result in serious injury or death if not avoided.		Never point the jet at people, animals, the device itself or live electrical devices.
 CAUTION !	Indicates a potentially hazardous situation which could result in damage to equipment or property.		

	In accordance with essential requirements of the European directive(s)		Read manual before use
	Slippery surface		Eye protection
	Risk of fire		Risk of electric shock
	Risk of explosion		Hot surface
	Carbon monoxide		Safety footwear

5 SAFETY INSTRUCTIONS

The manufacturer cannot anticipate every possible hazardous circumstance that the user may encounter. Therefore, the warnings in this manual, on tags, and on affixed decals are not all-inclusive. To avoid accidents, the user must understand and follow all manual instructions and use common sense.



WARNING! Read and understand this manual in its entirety before operating this pressure washer. Improper use of this pressure washer could result in serious injury or death.



This machine has been designed for use with the cleaning agent supplied or recommended by the manufacturer. The use of other cleaning agents or chemicals may adversely affect the safety of the machine.



Do not use the machine within range of persons unless they wear protective clothing.

- Spray from this unit has extreme pressure and can ricochet back splashing water or propelling objects towards eyes.
- Never substitute eye protection with dry condition goggles.
- Pressure washer can create puddles and slippery surfaces. Never wear sandals, always wear protective footwear.
- Operate pressure washer from a level and stable surface.
- Do not operate from a ladder, scaffolding, or uneven surface as recoil from spray gun could cause you to fall.
- Do not over-extend yourself in attempt to reach a little further.



WARNING! Do not direct the jet against yourself or others in order to clean clothes or foot-wear.



WARNING! Risk of explosion. Do not spray flammable liquids.



WARNING! High pressure cleaners shall not be used by children or untrained personnel.



WARNING! High pressure hoses, fittings and coupling are important for the safety of the machine. Use only hoses, fittings and couplings recommended by the manufacturer.



WARNING! To ensure machine safety, use only original spare parts from the manufacturer or approved by the manufacturer.



WARNING! Water that has flowed through backflow preventers is considered to be non-potable.



WARNING! The machine shall be disconnected from its power source during cleaning or maintenance and when replacing parts or converting the machine to another function.



WARNING! Do not use the machine if important parts of the machine are damaged, e.g. safety devices, high pressure hoses, trigger gun.



WARNING! Do not use combustion engine powered machines indoors unless adequate ventilation is assessed by national labour authorities.

- Carbon monoxide gas is a poisonous, odorless gas that can cause headache, confusion, fatigue, nausea, fainting, sickness, seizures, or death. If you start to experience any of these symptoms, IMMEDIATELY get fresh air and seek medical attention.
- Never use indoors, in a covered area, or in a confined space, even if doors and windows are open.



WARNING! Ensure that any exhaust emissions are not in the vicinity of air intakes.



WARNING! For gas or oil-heated machines it is important to provide adequate ventilation and make sure that the flue gases are properly discharged.



WARNING! Incorrect fuels shall not be used as they may prove hazardous



WARNING! Never spray near a power source such as an electrical outlet. Making contact with a power source could cause an electric shock or burn.



WARNING! Stay alert and use common sense. Do not operate this unit if you are under the influence of alcohol, drugs, medication or you feel tired.



WARNING! High pressure jets can be dangerous if subject to misuse. The jet must not be directed at persons, live electrical equipment or the machine itself.

- The high pressure stream of water produced can cut through skin and underlying tissue. Never squeeze the trigger or point the spray gun at other people, animals, plants, or fragile objects such as glass, even if the engine is stopped.
- This unit is not a toy. Keep unit away from children and pets.
- Do not leave spray gun unattended while unit is running.
- Make sure the spray gun, nozzle, and accessories are attached correctly.
- Never attempt to repair high pressure hose, always replace.
- Never attempt to repair leaks with sealant, always replace O-ring or seal.
- Never attempt to connect or disconnect hose from pump or spray gun while system is pressurized.
- Always release water pressure from unit every time you stop the engine.



WARNING! Avoid contacting hot areas of this unit.

- Use caution around the muffler, cylinder, and other engine parts as they can be extremely hot.
- Allow hot components to cool before touching.



WARNING! Moving parts can catch on clothing, jewellery, and hair.

- Do not wear loose clothing or gloves.
- Remove jewellery or anything else that could be caught in moving parts.
- Tie back or wear protective head covering to contain long hair.



WARNING! Keep engine away from flammable objects and other hazardous materials.

- The fuel and its vapours used to power this unit are highly flammable and could explode resulting in serious injury or death.
- Never overfill fuel tank. If fuel spills, move the unit at least 30 feet away from the spill and wipe up any remaining fuel on the unit before starting the engine.
- Never smoke while operating or fuelling this unit.
- Never operate or store this unit near an open flame, heat, or any other ignition source.
- Keep engine free of grass, leaves, or grease which are flammable.



- When adding or draining fuel, unit should be turned off for at least 2 minutes to cool before removing fuel cap. If unit has been running then the fuel cap is under pressure, remove slowly.
- To keep fuel from spilling, secure unit so it cannot tip while operating or transporting.
- When transporting unit, disconnect the spark plug wire and make sure the fuel tank is empty with the fuel shut-off valve turned to the off position.



WARNING! This machine can be used by people with reduced physical, sensory or mental capabilities or lack of experience and knowledge if they have been given supervision or instruction concerning use of the machine in safe way and understand the hazards involved.

6 ATTACHING WHEEL ASSEMBLY (SEE FIG. 1)

Parts needed - 2 hair pins, 2 wheels, 2 axles, 2 hub caps and 2 self-tapping screws.

- Slide the wheel axle pin through hole located in the centre of the wheel.
- Raise or tilt pressure washer so you can slide the wheel axle pin into the wheel mounting hole located on the side of the frame.
- Secure the wheel assembly by reinserting a hair pin through hole at the end of the wheel axle and pressing until it locks into place.
- Install the hub cap to the wheel until "Click" and install the self-tapping screw, until the screw is snug.
- Repeat process on the other side of the pressure washer to install the second wheel.

7 ATTACHING FOOT ASSEMBLY (SEE FIG. 1)

Parts needed - 2 foot, 2 M8 lock nuts.

- Raise or tilt pressure washer so you can line up foot with the hole located at the side of the frame opposite the wheel.
- Align the rubber foot with the hole in the frame where the foot is to be located. Attach foot by inserting the bolt from the bottom up and install the acorn nut. Wrench tighten until there is a slight crush on the frame tube. (Do not over tighten)

8 RAISING HANDLE (SEE FIG. 2)

Raise the handle, then screw the thumb knob nut until it is snug.

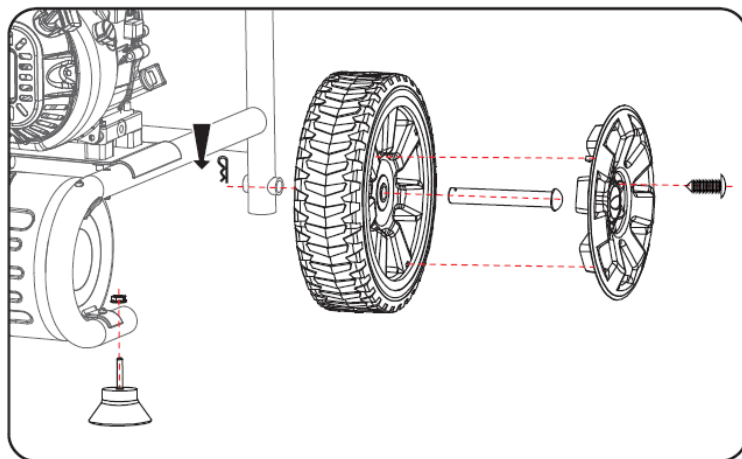

Fig. 1

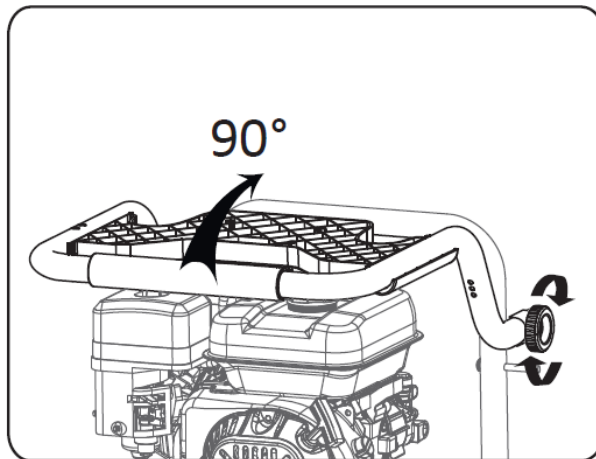

Fig. 2

9 ATTACHING UPPER AND LOWER GUN HOOKS (SEE FIG. 3)

Attach the upper and lower gun hooks.

- Install two M6 screws & the lock nuts, wrench tighten until the nuts are snug.

10 ATTACHING HIGH PRESSURE HOSE HOOK (SEE FIG. 4)

Align the hole of the high pressure hose hook to hole on the handle bar.

- Install four self-tapping screws, until the screws are snug.

11 ATTACHING ACCESSORY HOOK (SEE FIG. 4)

- Align the accessory hook with the holes.
- Install two plastic rivets, until the plastic rivet is snug.
- Press hard with your finger to lock the rivet.

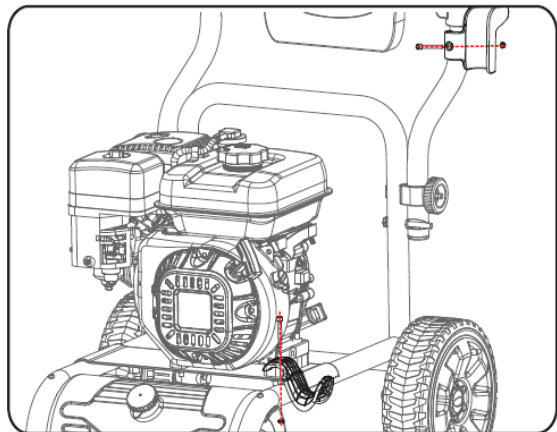

Fig. 3

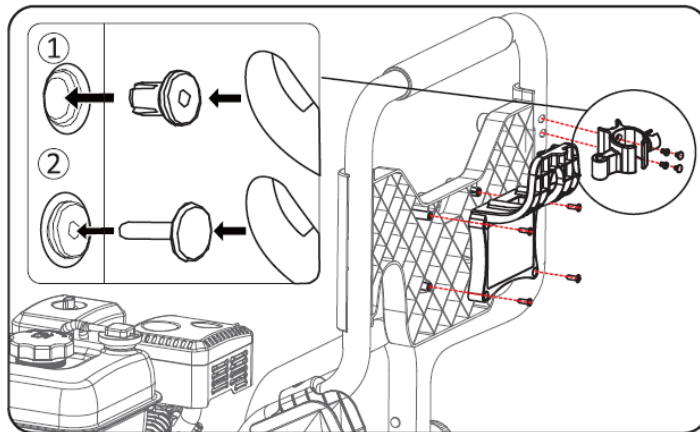

Fig. 4

12 ATTACHING THE SPRAY GUN (SEE FIG. 5 & 6)

Screw the spray wand and the trigger handle together until they are secure.

Insert the inlet coupler of the spray hose into the threaded fitting on the high pressure spray gun and thread the black nut on by turning clockwise until it is hand tight.

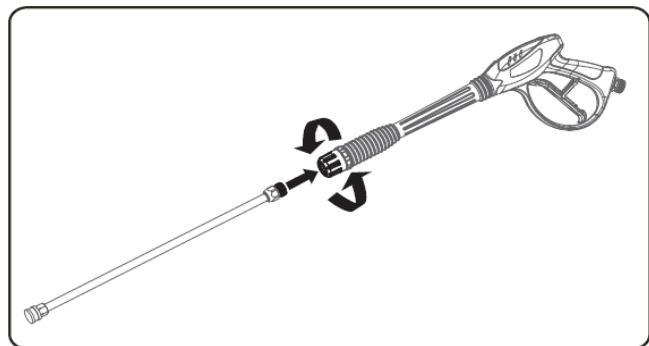

Fig. 5

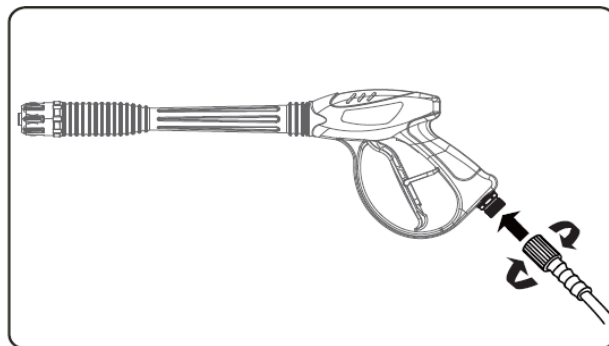

Fig. 6

13 ADDING / CHECKING ENGINE OIL (SEE FIG. 7)

- Place pressure washer on a level surface.
- Remove one or both of the crankcase dipsticks to ensure you do not overfill the engine.
- Carefully add 520 ml (17.6 oz) of 4-Cycle engine oil (SAE10W30) to empty reservoir until oil reaches the outer edge of the oil fill hole (Crankcase Dipstick hole).
- Be sure to replace both dipsticks before attempting to start the engine.
- To check oil, set pressure washer on a level surface, wipe dipstick clean, then reinsert dipstick without re-threading.

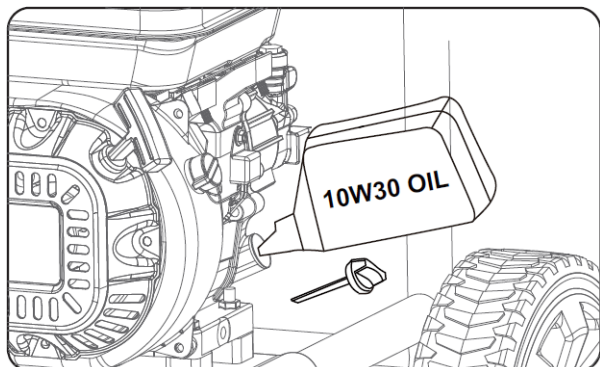

Fig. 7

14 ADDING FUEL (SEE FIG. 8)

Set pressure washer on a clean and level surface in an area that is well ventilated.

- Remove fuel cap.
- Insert a funnel into the fuel tank and carefully pour gasoline into the tank until fuel level reaches 1 1/2 inches below the top of the neck.



CAUTION! Oil must be added to unit prior to first use.



CAUTION! To avoid spillage, do not overfill fuel tank as gasoline expands.

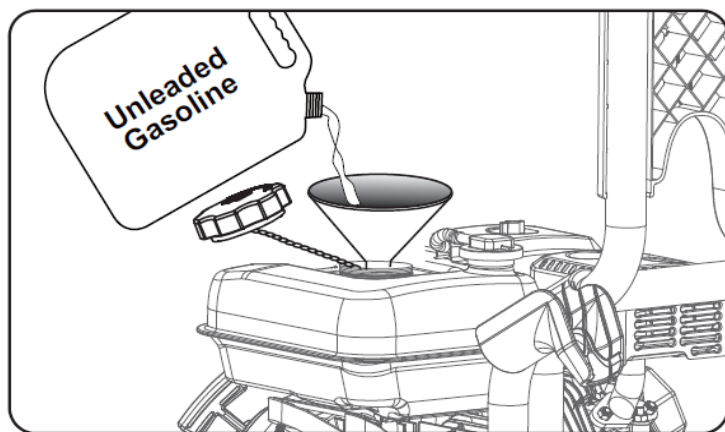

(Unleaded gasoline: unleaded gasoline)

Fig. 8

15 CONNECTING GARDEN HOSE TO PRESSURE WASHER (SEE FIG 9)

- Run water through the hose for a few seconds to flush any debris from the hose.
- Inspect inlet screen and remove any debris.
- Connect hose to water inlet and tighten by hand. There must be a minimum of 10 feet of unrestricted hose between pressure washer and faucet or shut off valve.
- Turn on water.
- Purge the system's pump of air by releasing the safety and squeezing the trigger of the spray gun.



CAUTION! Do not run pump without connecting to the water supply and turning water on. Failure to do so could damage the pressure washer. Failure to follow these instructions will void product warranty.

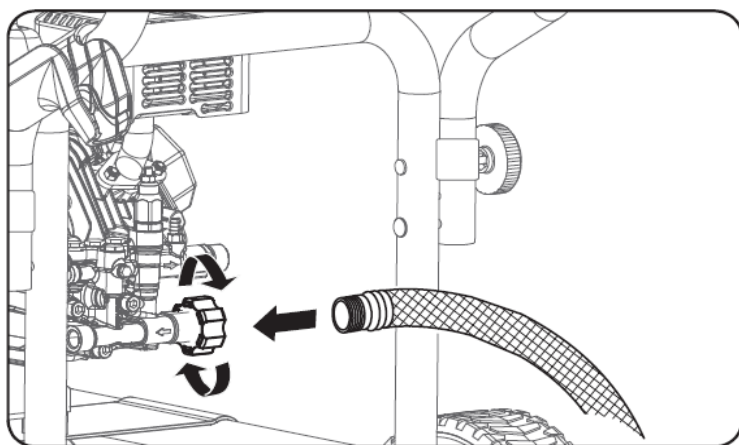

Fig. 9

16 CONNECT HIGH PRESSURE HOSE TO PUMP (SEE FIG. 10)

- Attach end of high pressure hose to the high pressure outlet on pump.
- Follow the same procedure with opposite end to attach high pressure hose to spray wand.

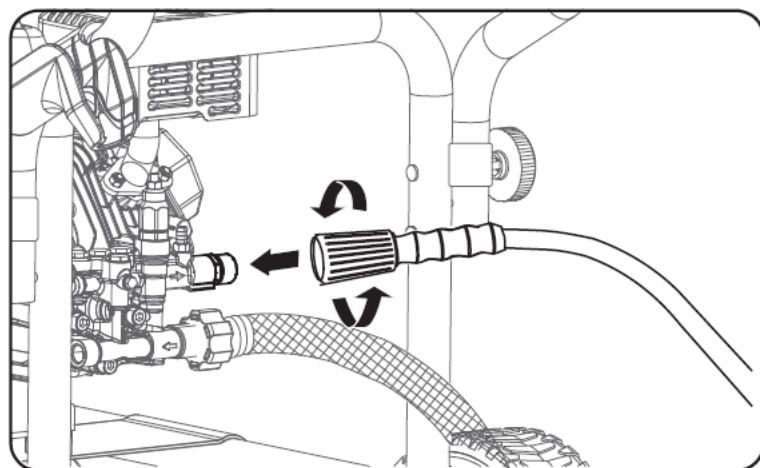

Fig. 10

17 PRE-OPERATION CHECK LIST

- Read and understand this operator manual in its entirety before operating pressure washer.
- Check oil level and add oil to the proper level if low.
- Check fuel level and add fuel if needed.
- Check connections of handle and all hoses to make sure they are secure.
- Check all hoses for kinks and damage.
- Check flow of water supply and make sure it is adequate (2.75 – 5.5 bar) (40 – 80 PSI).



WARNING! Do not operate indoors or in a confined space preventing dangerous carbon monoxide gas from dissipating.

- Carbon monoxide gas is a poisonous, odourless gas that can cause headache, confusion, fatigue, nausea, fainting, sickness, seizures, or death. If you start to experience any of these symptoms, **IMMEDIATELY** get fresh air and seek medical attention.
- Never use indoors, in a covered area, or in a confined space, even if doors and windows are open.
- Keep exhaust from this unit from entering a confined area through windows, doors, vents, or other openings.
- When working in areas where vapours could be inhaled, use a respirator mask according to all of its instructions.



CAUTION! Do not run pressure washer with a damaged hose. Do not run pressure washer without first connecting and turning on water supply or damage to the pressure washer could result.

FAILURE TO FOLLOW THESE INSTRUCTIONS WILL VOID PRODUCT WARRANTY

18 STARTING PRESSURE WASHER (SEE FIG. 11-12)

- Place pressure washer on a level surface.
- Turn on water.
- Purge the system's pump of air by releasing the safety and squeezing the trigger of the spray gun.
- Attach wand/lance to spray gun.
- Turn fuel valve to the ON position.
- Slide the choke lever to the "Choke" position.
- Turn the engine OFF/ON switch to the "ON" position.
- Holding the machine with your hand, pull the recoil handle (starter cord) slowly until resistance is felt, then pull rapidly. Squeeze the Gun trigger and release the pressure after every failed attempt to start the pressure washer (This will reduce the back pressure).
- Let engine run for several seconds and then gradually slide the choke lever to the RUN position as the engine warms up until the choke is fully slid to the RUN position.

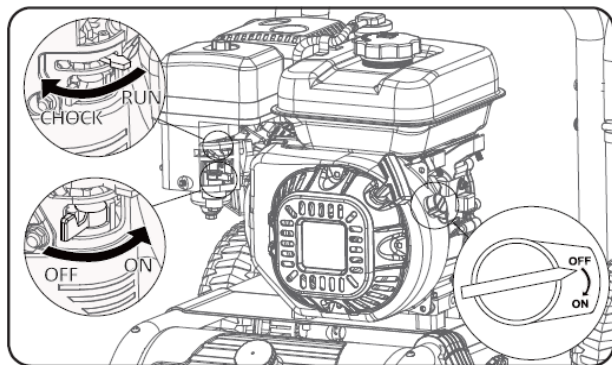

FIG. 11

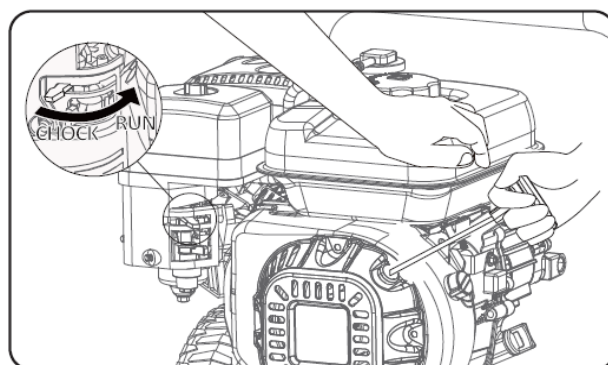

FIG. 12



WARNING! Risk of Injection or Injury – Do Not Direct Discharge Stream At Persons.

This pressure washer is equipped with a thermal relief valve (TRV). The TRV is a temperature actuated valve that will open and allow cool water to pass from the garden hose through the pump head to cool the head if the pump reaches 60 °C (140 °F). The water will flow from the garden hose through the head and discharge from the pump to the ground through the TRV elbow. The TRV elbow must always be facing downward to allow the heated water to spray toward the ground. This valve will open if the unit is left running for several minutes without squeezing the trigger of the spray gun. Spraying the gun allows the pump to cool by passing fresh cool water from the garden hose through the pump head.



WARNING! Pull cord recoils rapidly and pulls arm towards engine faster than you can let go which could result in injury.

- Always relieve pressure from spray gun before pulling starter cord, including every failed attempt to start engine.
- To avoid recoil, pull starter cord slowly until resistance is felt, then pull rapidly.

19 STOPPING PRESSURE WASHER (SEE FIG. 13)

Turn the on/stop switch to the OFF position.

- Turn the fuel valve to the OFF position.
- Turn off water and squeeze the trigger handle to release all water pressure.

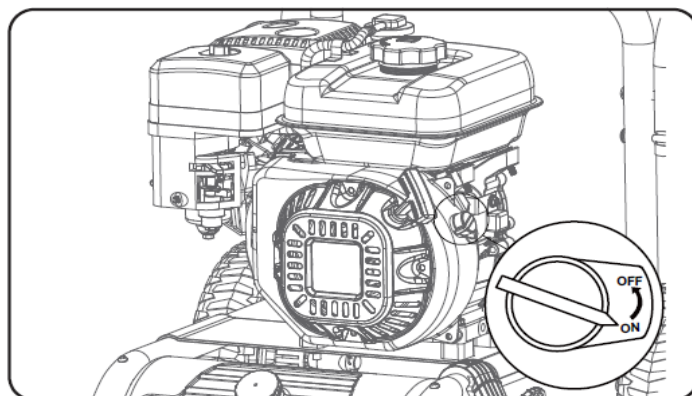

Fig. 13



WARNING! Know how to stop the product and bleed pressures quickly. Be thoroughly familiar with the controls.

20 USING THE SPRAY GUN (SEE FIG. 14 - 15)

- Flip the lock tab behind the trigger up or down until it clicks to apply or remove the safety. Pull back on the trigger to begin operating pressure washer.
- To stop water flow, release trigger.

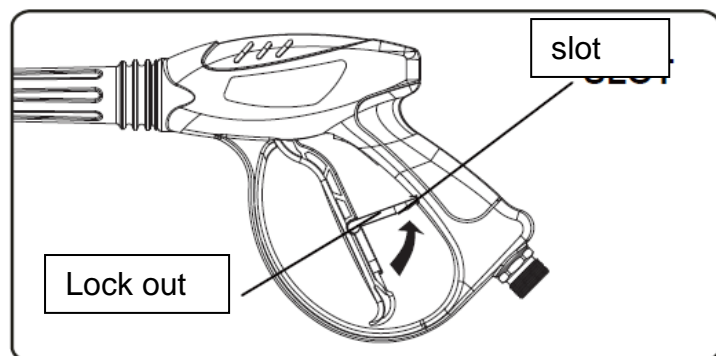

Fig. 14

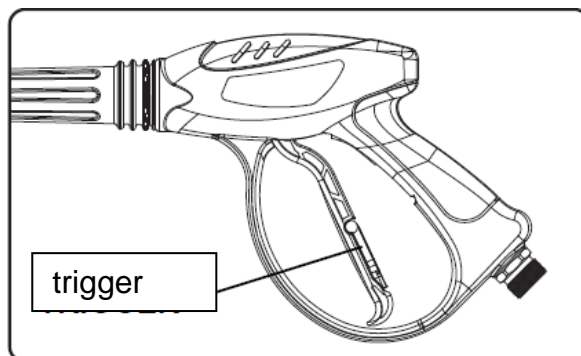

Fig. 15

21 USING SPRAY NOZZLE (SEE FIG. 16)

- To connect or disconnect spray tip, pull back on the quick-connect collar. Insert or remove spray tip then release collar.
- When spray tip is connected, pull on the spray tip to make sure it is secured.
- For general cleaning use the 40° spray tip. This option is for cement walkways.
- For stripping, spot cleaning, blasting, and hard to reach areas use the 25° spray tip. This option is for removing paint, rust, mildew, marine growth off boats, or grease stains. This option can be used for reaching second story surfaces, or for the removal of paint, rust, oil stains, tar, gum, and other stubborn substances. Use extreme caution when using this nozzle.
- For applying pressure washer safe detergent, use the black soap nozzle.

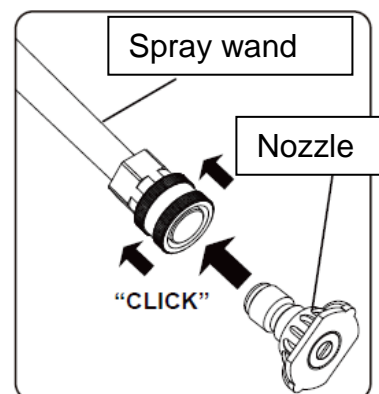

Fig. 16



WARNING! Risk of injection or severe injury – Keep clear of nozzle – Do not direct discharge stream at persons – This product is to be used only by trained operator.

22 APPLYING DETERGENT

- Rinse surface with cool water before applying cleaner.
- Prepare detergent as required by job. For best results follow detergent directions as supplied from manufacturer.
- Remove cap from detergent container and fill.
- Spray detergent on surface. For best results use long, even, and overlapping strokes. Allow detergent to set for about 3 minutes before rinsing, but do not allow detergent to dry on surface or it may cause streaking or cause damage to the surface. Use good judgment.
- To clean equipment after use, flush water through the spray nozzle for 1-2 minutes then shut off engine. Soak nozzle in a bucket of clean water to remove detergent.



WARNING! Only use detergents or soaps that are safe to be used with pressure washers. Chemicals which are caustic, such as acids or bleach, can result in serious injury, property damage, or death.

23 RINSING WITH THE PRESSURE WASHER

- Test a small area first to avoid surface damage.
- Rinse from top to bottom using long, overlapping strokes.

24 MOVING THE PRESSURE WASHER

- Turn the pressure washer off.
- Tilt unit towards you until it is balanced on its wheels.
- Roll machine to desired location.



WARNING! Do not overreach or stand on unstable support. Keep good footing and balance at all times.



WARNING! Keep operating area clear of all persons.



25 MAINTENANCE

Regular maintenance will extend the life of this pressure washer and improve its performance. The warranty does not cover items that result from operator negligence, misuse, or abuse. To receive full value from the warranty, operator must maintain the pressure washer as instructed in this manual, including proper storage.



WARNING! Follow the maintenance instructions specified in the manual



WARNING! Before inspecting or servicing this machine, make sure the engine is off and no parts are moving. Disconnect the spark plug wire and move it away from the spark plug.

26 PRE-OPERATION STEPS

Before starting the engine, perform the following pre-operation steps:

- Check the level of the engine oil and the fuel tank level.
- Make sure the air filter is clean.
- Remove any debris that has collected on the pressure washer.
- Check water inlet screen for damage. Clean inlet screen if it is clogged.
- Check high pressure hose for damage.
- Briefly run garden hose to flush out any debris or insects.
- Inspect the work area for hazards.

27 REMOVE DEBRIS

- Clean any debris that has collected around or behind the muffler, cleaning system, and controls.
- Use a damp cloth to wipe exterior surfaces. If dirt is caked on, use a soft bristle brush

28 AFTER EACH USE

Follow the following procedure after each use:

- Shut off engine and turn off water supply. Release water pressure by pointing spray gun in a safe direction and squeezing the trigger.
- Disconnect high pressure hose, spray gun, and nozzle. Drain water from items and use a rag to wipe down the outside of the hose and spray gun.
- Empty the water from the pump by pulling the recoil starter 6 times.
- Store unit in a clean and dry area.
- Use of a pressure washer pump conditioner is recommended, follow the instructions provided by the manufacturer of the pump conditioner.

29 MAINTENANCE SCHEDULE

After first 5 hours	Change engine oil
After each use	Check and clean water inlet screen
	Check high pressure hose
	Check and clean detergent siphoning tube
	Check spray gun for leaks
	Clean debris
	Check engine oil level before starting
Annually (20 hr use)	Change engine oil (Service more often under dirty or dusty conditions)
Annually (50 hr use)	Check and clean air filter
*	Check muffler and spark arrester
Annually (100 hr use)	Service or replace spark plug



CAUTION! Risk of injury. If the pressure washer is equipped with a battery, disconnect the battery ground wire before servicing.

30 CHANGING ENGINE OIL

Engine oil will drain better if the engine is still warm, but not hot.

- Shut off engine.
- Clean the area around the oil fill cap/dipstick to keep out debris then remove oil fill cap/dipstick.
- Place an oil pan on the ground to catch oil. Remove oil plug then tilt pressure washer back and to the side to empty out the oil from the crankcase.
- Once oil is completely drained, return the pressure washer to a level position and install the oil drain plug. Refill the engine with new oil as instructed earlier in this manual under Adding/Checking oil.

Oil drain plug

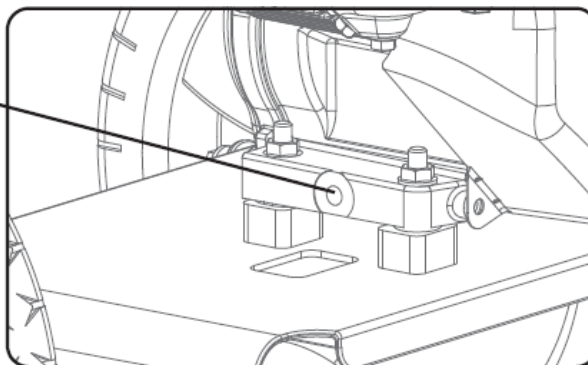

31 CHECKING DETERGENT SIPHONING TUBE

- Check the detergent siphoning tube for clogs, leaks, or tears.
- Make sure the tube fits tightly to the pump fitting.
- Replace siphoning tubes if damaged.



WARNING! Never repair high pressure hose or use unit if hose is damaged. If hose is damaged replace with identical factory part.

32 HIGH PRESSURE HOSE

- Inspect hose for cuts, bulges, or leaks which can develop from kinking or wear. If damage is found, immediately replace hose.
- Inspect couplings for damage. Immediately replace hose if damage is found.

33 SPRAY GUN

- Make sure the spray gun is connected securely.
- Inspect the spray gun safety and make sure the spray gun trigger springs back upon release.

34 SPRAY NOZZLE

If a pulsing sensation is felt while squeezing the trigger, the spray nozzle may be dirty or clogged and should be cleaned immediately.

- To clean the nozzle, shut off the engine and turn off the water.
- Remove the nozzle from the spray wand making sure that the nozzle is pointing away from you and in a safe direction.
- Use the nozzle cleaner or a small paper clip to dislodge any foreign materials which are clogging or restricting the spray tip.
- Flush debris out of the nozzle by back flushing with a garden hose for 30-60 seconds.
- Reconnect the nozzle to the spray wand.
- Turn the water supply back on and start engine.



35 CHECKING SPARK PLUG

- Disconnect the spark plug wire from the spark plug.
- Before removing the spark plug, clean the area around its base to prevent debris from entering the engine.
- Clean carbon deposits off the electrode with a wire brush.
- Check the electrode gap and slowly adjust to 0.80 mm (0.031 in.) if necessary.
- Reinstall spark plug and tighten to Torque 22.0 – 26.9 Nm (16-20 ft-lb).
- Reconnect spark plug wire.
- If spark plug is worn replace only with an equivalent replacement part. Spark plug should be replaced annually



WARNING! Water pressure produced by this unit can cut through skin and tissue leading to serious injury and possible amputation.

- Never attempt to repair high pressure hose, always replace.
- Never attempt to repair leaks with sealant, always replace O-ring or seal.

36 REPAIRING LEAKING CONNECTIONS

- Purchase O-Ring / Maintenance kits through the nearest authorized service centre and follow instructions provided with kit.

37 AIR FILTER

A dirty air filter will reduce the life span of the engine, make starting the engine more difficult and reduce the unit's performance.

- To clean, remove the air filter cover.
- Carefully pull the air filter out by lifting up along the edges.
- Remove dirt from filter by tapping on it or having it blown out.
- Reinstall air filter so that it seals and reposition air filter cover.



WARNING! Storage cover could be flammable. Let engine cool before covering pressure washer.

**38 STORING PRESSURE WASHER**

If storing pressure washer for 30 days or more follow the procedures below:

- Add fuel stabilizer to gasoline to keep gasoline from going stale and to prevent gum deposits from forming on the carburettor. Run engine for a couple of minutes to circulate the fuel stabilizer.
- Add pump saver to protect pump from freezing or damage caused by mineral deposits.
- Empty fluid from all hoses and pump.
- Disconnect the spark plug wire and clean the spark plug. Leave spark plug wire disconnected.
- Clean the air filter.
- Cover unit with a suitable protective cover to keep unit dry.
- Store unit in a frost-free area.

39 TROUBLESHOOTING

PROBLEM	CAUSE	SOLUTION
Engine does not start	1. Out of fuel 2. Engine oil low 3. Spark plug wire disconnected from spark plug 4. Bad spark plug 5. Spark plug wire has shorted 6. Ignition inoperative	1. Fill fuel tank 2. Add engine oil 3. Connect spark plug wire 4. Replace spark plug 5. Contact service centre 6. Contact service centre
Engine hard to start	1. Stale fuel or water in fuel 2. Spark plug producing weak spark 3. Excessively rich fuel mixture	1. Drain fuel and refill with fresh gasoline. 2. Contact service centre 3. Contact service centre
Engine lacks power and vibrates excessively	Dirty air filter	Clean Air filter
Engine quits during operation	Out of fuel	Fill fuel tank
Engine loses power when load is added	1. Engine speed is too slow	1. Move throttle to fast. If this does not correct problem, contact service centre
Water pressure is weak	1. Water supply is restricted. 2. Water not turned on to full power 3. Not using high pressure nozzle	1. Inspect garden hose for kinks or leaks. Make sure you are using a large enough garden hose (min. Ø19 mm/¾") 2. Open water source all the way. 3. Change nozzle
Detergent and spray do not mix	1. Detergent hose is not submerged or has disconnected 2. Black soap nozzle needed	1. Make sure hose is connected and submerged in the detergent 2. Install soap nozzle
Pump fails to produce pressure or pressure is inconsistent	1. Water supply is restricted 2. Water not turned on full power 3. Nozzle is clogged 4. Spray gun leaks 5. Air in line 6. Inlet hose screen is clogged 7. Water supply is over 60 °C (100 °F) 8. Pump is faulty	1. Inspect garden hose for kinks or leaks. Make sure you are using a large enough garden hose (min. Ø19 mm/¾") 2. Open water source all the way. 3. Clean nozzle 4. Check spray gun connection or replace spray gun 5. Squeeze trigger handle to remove air 6. Clean inlet 7. Use cool water supply 8. Contact service centre

**40 TECHNICAL DATA**

Model	FPWG2700H-J-EU	FPWG3100H-J-EU
Engine	180 CC OHV, 4 Stroke, Air Cooled	208CC OHV, 4 Stroke, Air Cooled
Rated speed	3000 min ⁻¹	3000 min ⁻¹
Engine Oil type / volume	10W30 – 0.6 L	10W30 – 0.6 L
Fuel type	Unleaded gasoline	Unleaded gasoline
Rated Max. Pressure	186 bar (18.6 MPa)	213 bar (21.3 MPa)
Allowable Pressure	206 bar (20.6 MPa)	233 bar (23.3 MPa)
Rated water flow	8.7 l/min (522 l/h)	9.5 l/min (568 l/h)
Max. water flow	8.7 l/min (522 l/h)	9.5 l/min (568 l/h)
Max. Water intake temperature	50° C	50°C
Detergent Tank	4.7 liter	2 x 2.3 liter
Nozzles	0° / 25° / 40° / Soap nozzle	0° / 15° / 25° / 40° / Soap nozzle / Rotating (turbo) nozzle
Water hose diameter	Min. ½"	Min. ½"
Kick back force on lance	28 N	33 N
Net Weight	28 kg	30 kg
Engine :		
Model	FE180	FE208
Displacement	180 CC	208CC
Power	3.8kW @ 3600rpm	4.2kW @ 3600rpm
Fuel tank capacity	3.6 liter	3.6 liter

41 NOISE

Noise values measured according to relevant standard. (**EN ISO 4871:1996**). (K = 3)

	FPWG2700H-J-EU	FPWG3100H-J-EU
Acoustic pressure level L_{pA}	95 dB(A)	95 dB(A)
Acoustic power level L_{WA}	105 dB(A)	105 dB(A)

Values determined according to noise test code given in Annex CC of EN 60335-2-79:2012, using the basic standard EN ISO 3744:2010.

NOTE: Declared single-number noise emission values are the sum of measured values and the associated uncertainty, and they represent upper boundaries of the range of values which is likely to occur in measurements.



ATTENTION! The sound power level may exceed 75 dB(A), in this case individual hearing protection shall be worn.

42 VIBRATION

Declared vibration emission values of a single machine (In accordance with EN ISO 12096:1997)

Measured vibration emission value a	FPWG2700H-J-EU	FPWG3100H-J-EU
Handle of trigger gun	0.828 m/s ²	2.584 m/s ²
Middle of trigger gun	2.068 m/s ²	6.522 m/s ²

Values determined according to vibration test code given in Annex DD of EN 60335-2-79:2012, using the basic standard ISO 5349-1:2001.

**43 SERVICE**

How to contact us: (To order parts, receive warranty assistance, or other services inquiries)
Please see contact data on the back of this manual.

Record the following information bellow for service or warranty assistance

Date of Purchase:	
Model Number:	
Series Number:	
UPC Number:	